

**BERECO
OPENING OUT
FOLDING DOOR
INSTRUCTIONS**



HOW TO FIT THE FRAME INTO THE OPENING

Proceed to install the assembled frame ensuring that the cill faces to the outside. It is critical that the frame is fitted square and level with tolerances as shown in Diagram 1.

Ensure the frame is installed plumb and square where necessary using packers between the frame and the brick opening.

The diagonals must be the same dimension. +/- 2mm.

We recommend that the top centre of the frame is bowed upwards by 3mm with packers placed at the top of both jambs.

Using all available pre drilled fixing points fix the top of the frame securely into the lintel.

Important: the head section of the frame must not sag otherwise operation will be compromised.

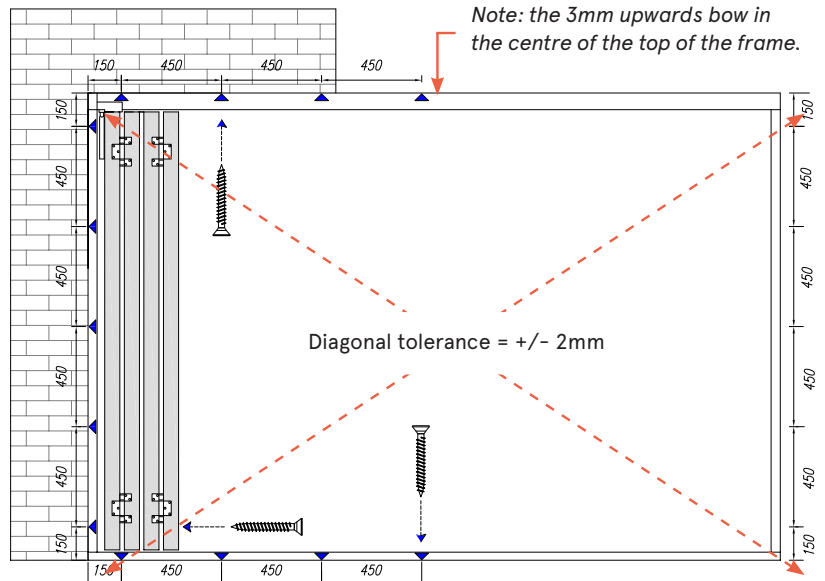
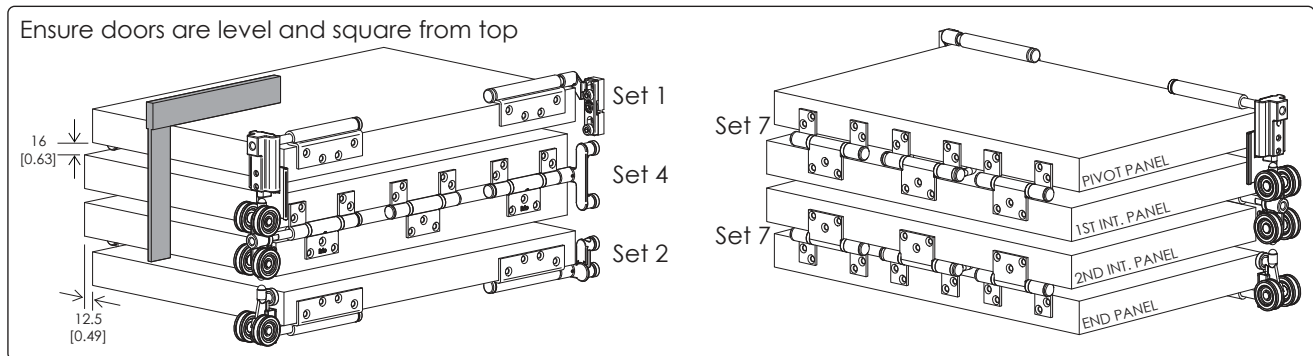

Diagram 1.

HOW TO FIT THE DOOR LEAVES TO THE FRAME

Attaching hardware to panels (if supplied loose)



Installing hardware & attaching panels (before completing installation of the panels ensure that both track and channel are clean and free of any debris)

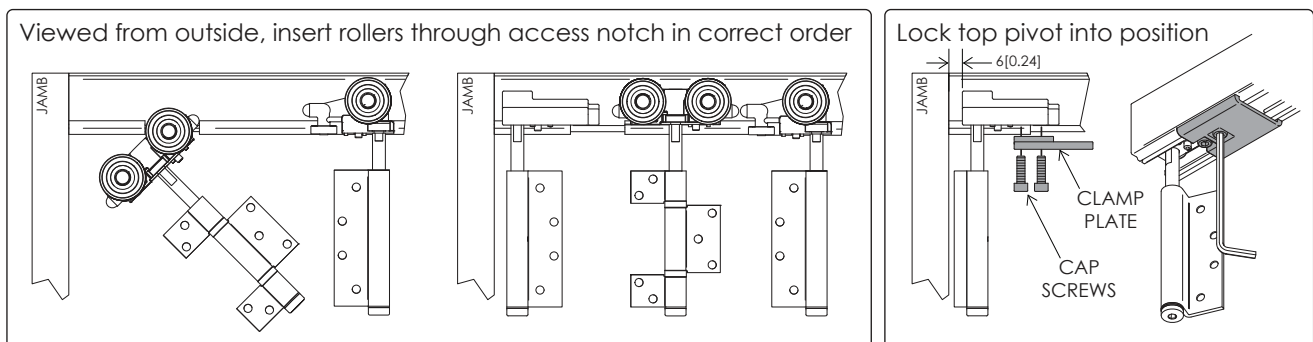

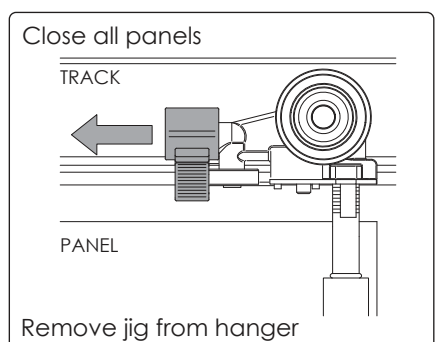
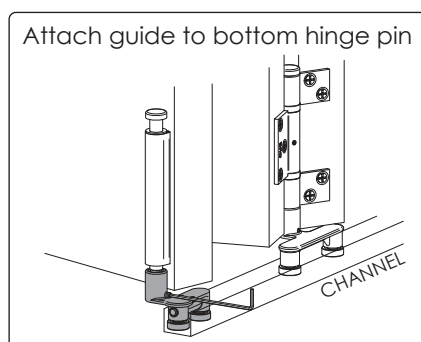
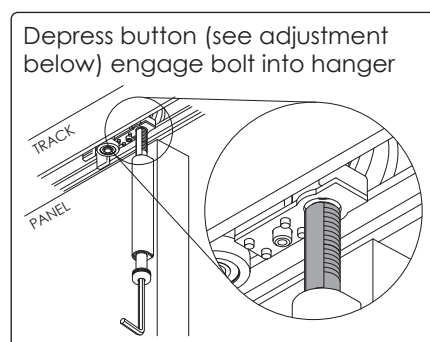
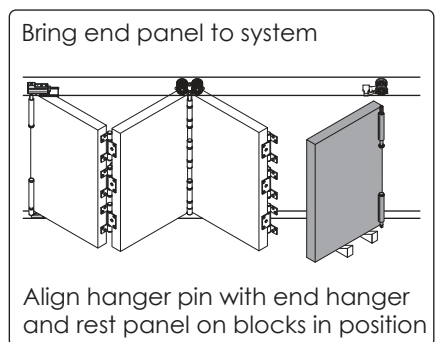
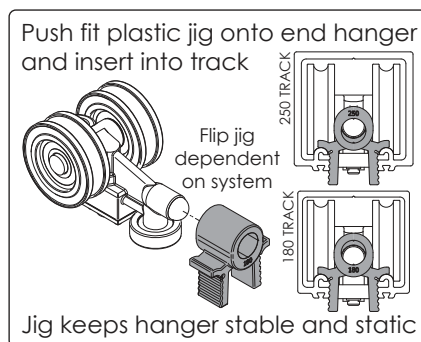
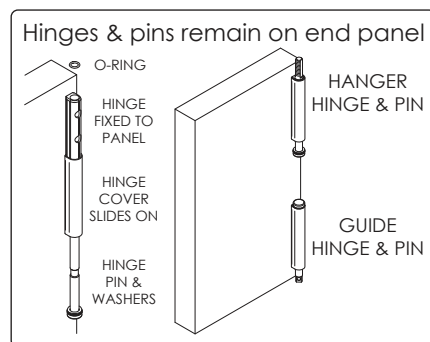
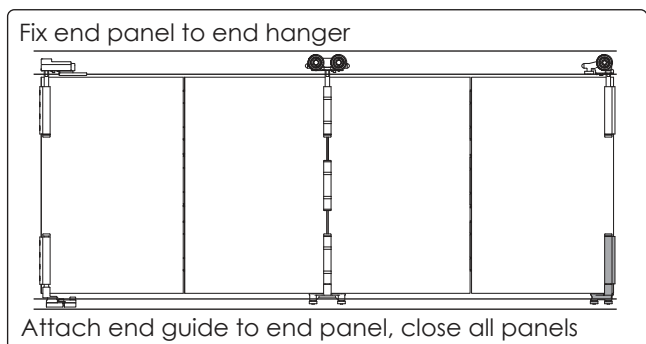
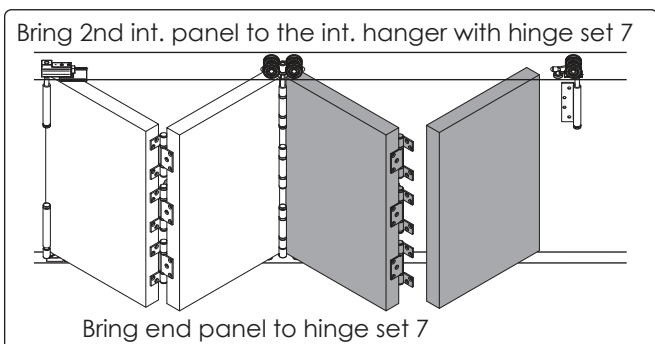
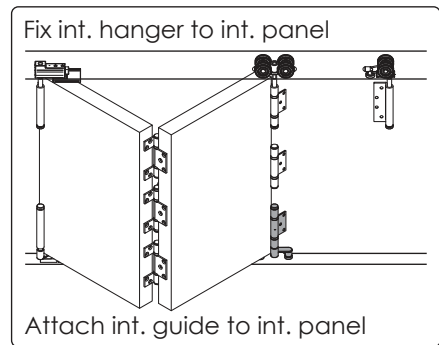
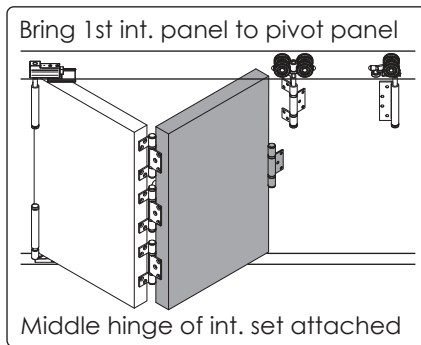
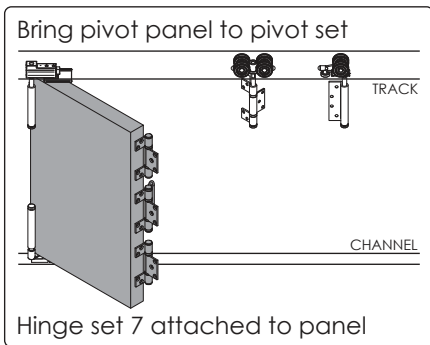
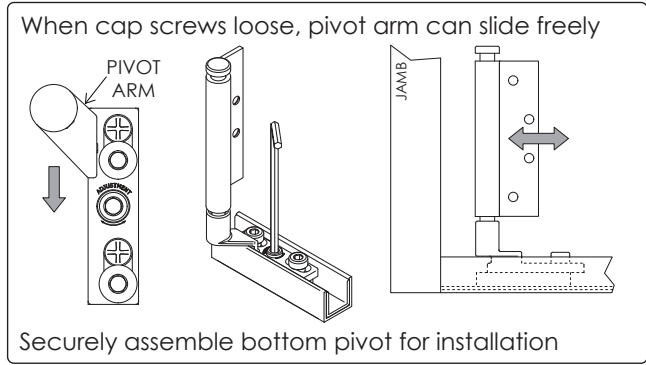
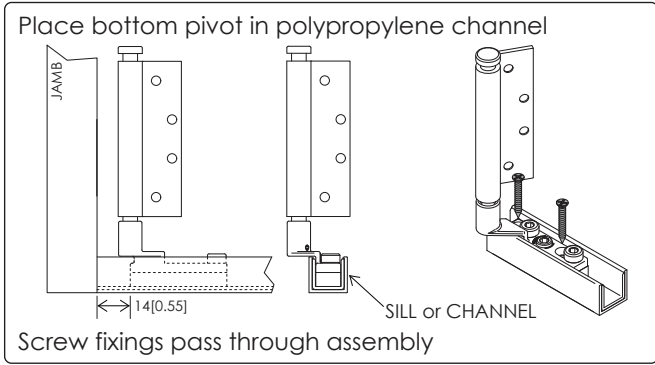

ADJUSTMENT

Push in spring loaded button

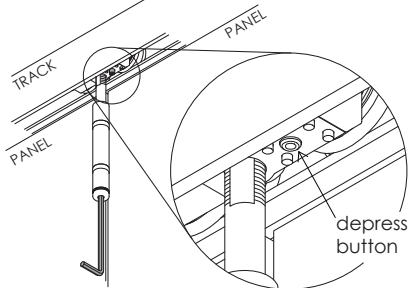

Wind pin into hanger - hanger automatically locks off on bolt flats

Loosen bottom pivot cap screws

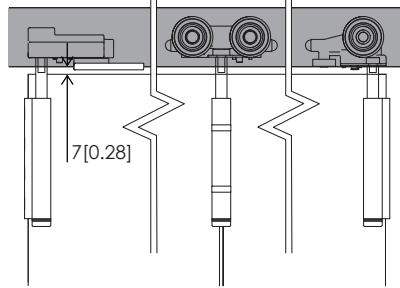

Adjust all hangers and top pivot until panels are level with track

Once panels are level, partially open doors - lock off 1st cap screw

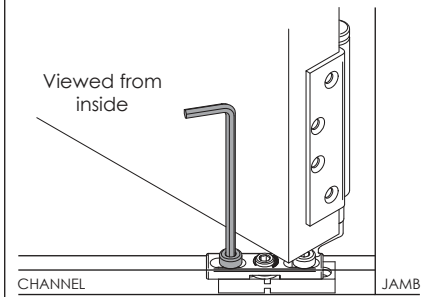

Open fully, lock off 2nd cap screw

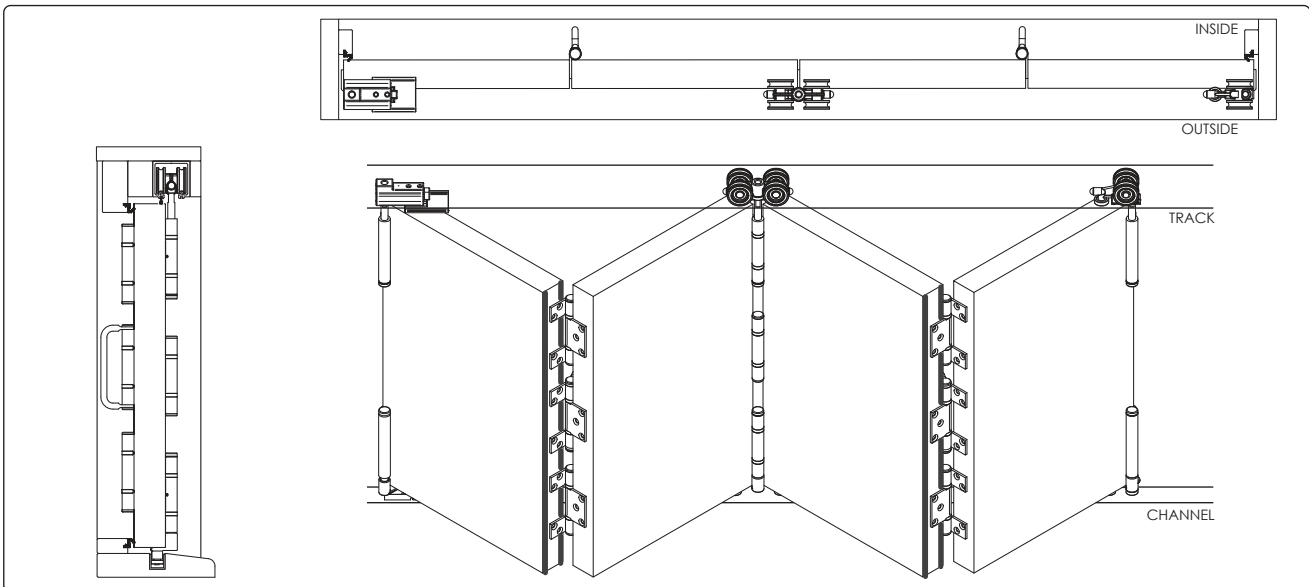

CARE & MAINTENANCE

Hardware is subject to deterioration from everyday use and from the environment that it is in. In particular, it is important that routine maintenance be carried out in harsh coastal or marine environments and industrial applications.

GENERAL

Inspect all fixing bolts for tightness every six months, including those securing brackets. Tighten if necessary. Routinely check for wear and if excessively worn, the part should be replaced.

To help prevent surface corrosion, Brio recommends washing regularly; even stainless steel finishes in coastal environments may show signs of surface corrosion if not washed regularly. Sheltered areas that are not rain washed are particularly susceptible. Wash with soap or mild detergent and warm water followed by rinsing with clean cold water and wipe dry.

As a guide, if a window or door requires washing then wash the hardware, however recommend for marine and industrial environments washing a minimum of every 3 months and 6 months for general environments. In coastal or marine environments recommends applying a light application of corrosion preventative such as CRC Marine 66 or Inox for Marine, to all surfaces and using a dry cloth to remove excess. When using lubricant or corrosion protection compounds, be careful to avoid the adjacent surfaces and always follow the manufacturer's instructions.

TRACK

Keep track free from obstruction and excessive dirt or water. Visible surfaces should be cleaned using a damp cloth and mild detergent, then wiped dry. Where fitting to the outside of the building, it is recommended that the appropriate track is specified.

GUIDES

Guide roller and guide channel must be kept clear and free of obstructions. Wash as per the above recommendation and apply a light application of corrosion preventative to all surfaces, using a dry cloth to remove excess.

HINGES

Visible surfaces should be cleaned using a damp cloth and mild detergent, then wiped dry. Apply a light application of corrosion preventative to all surfaces, using a dry cloth to remove excess. Repeat at intervals no greater than 3 months.

HANGERS & PIVOTS

All hangers are fitted with lubricated ball-bearings or plain bearings, requiring no greasing. If doors 'settle' and door clearance is reduced causing friction, raise the door by the hanger adjustment nuts.

Wash as per the above recommendation and apply a light application of corrosion preventative to all surfaces, using a dry cloth to remove excess.

ROLLERS

All bottom rails should be free from obstruction and excessive dirt or water. Visible surfaces should be cleaned using a damp cloth and mild detergent, then wiped dry. All rollers are fitted with sealed precision bearings requiring no maintenance.

FLUSH BOLTS

Visible surfaces should be cleaned using a damp cloth and mild detergent, then wiped dry. Apply a light application of lubricant to internal mechanisms and bolt using a suitable nozzle-spray.

TIMBER
ECO
PERFORMANCE
SECURE
CHOICE
BESPOKE



01709 838188

enquiries@bereco.co.uk

WWW.BERECO.CO.UK